



## TESTA PORTACOLTELLI SPECIALE PER COLTELLI AFFILIBILI, PP 0 ÷ 20 mm

Special cutter head with profiled knives,  
PP from 0 to 20 mm

Sonder Proflierter Messerkopf, PP vom 0 bis 10 mm

Cabezal portacuchillas especial perfiladas,  
PP de 0 a 20 mm

### CORPO IN ACCIAIO

Steel body

Körper aus Stahl

Cuerpo en acero

### 0 ÷ 10

D mm	B mm	Z
140	20	4
160	20	4
200	20	4
250	20	4
300	20	4
140	30	4
160	30	4
200	30	4
250	30	4
300	30	4
140	40	4
160	40	4
200	40	4
250	40	4
300	40	4
140	50	4
160	50	4
200	50	4
250	50	4
300	50	4
140	60	4
160	60	4
200	60	4
250	60	4
300	60	4
140	80	4
160	80	4
200	80	4
250	80	4
300	80	4

CODICE CODE	P.P. mm
AT110001	0 ÷ 10
AT110002	0 ÷ 10
AT110003	0 ÷ 10
AT110004	0 ÷ 10
AT110005	0 ÷ 10
AT110006	0 ÷ 10
AT110007	0 ÷ 10
AT110008	0 ÷ 10
AT110009	0 ÷ 10
AT110010	0 ÷ 10
AT110011	0 ÷ 10
AT110012	0 ÷ 10
AT110013	0 ÷ 10
AT110014	0 ÷ 10
AT110015	0 ÷ 10
AT110016	0 ÷ 10
AT110017	0 ÷ 10
AT110018	0 ÷ 10
AT110019	0 ÷ 10
AT110020	0 ÷ 10
AT110021	0 ÷ 10
AT110022	0 ÷ 10
AT110023	0 ÷ 10
AT110024	0 ÷ 10
AT110025	0 ÷ 10
AT110026	0 ÷ 10
AT110027	0 ÷ 10
AT110028	0 ÷ 10
AT110029	0 ÷ 10
AT110030	0 ÷ 10

### 11 ÷ 15

CODICE CODE	P.P. mm
AT115001	11 ÷ 15
AT115002	11 ÷ 15
AT115003	11 ÷ 15
AT115004	11 ÷ 15
AT115005	11 ÷ 15
AT115006	11 ÷ 15
AT115007	11 ÷ 15
AT115008	11 ÷ 15
AT115009	11 ÷ 15
AT115010	11 ÷ 15
AT115011	11 ÷ 15
AT115012	11 ÷ 15
AT115013	11 ÷ 15
AT115014	11 ÷ 15
AT115015	11 ÷ 15
AT115016	11 ÷ 15
AT115017	11 ÷ 15
AT115018	11 ÷ 15
AT115019	11 ÷ 15
AT115020	11 ÷ 15
AT115021	11 ÷ 15
AT115022	11 ÷ 15
AT115023	11 ÷ 15
AT115024	11 ÷ 15
AT115025	11 ÷ 15
AT115026	11 ÷ 15
AT115027	11 ÷ 15
AT115028	11 ÷ 15
AT115029	11 ÷ 15
AT115030	11 ÷ 15

### 16 ÷ 20

CODICE CODE	P.P. mm
AT120001	16 ÷ 20
AT120002	16 ÷ 20
AT120003	16 ÷ 20
AT120004	16 ÷ 20
AT120005	16 ÷ 20
AT120006	16 ÷ 20
AT120007	16 ÷ 20
AT120008	16 ÷ 20
AT120009	16 ÷ 20
AT120010	16 ÷ 20
AT120011	16 ÷ 20
AT120012	16 ÷ 20
AT120013	16 ÷ 20
AT120014	16 ÷ 20
AT120015	16 ÷ 20
AT120016	16 ÷ 20
AT120017	16 ÷ 20
AT120018	16 ÷ 20
AT120019	16 ÷ 20
AT120020	16 ÷ 20
AT120021	16 ÷ 20
AT120022	16 ÷ 20
AT120023	16 ÷ 20
AT120024	16 ÷ 20
AT120025	16 ÷ 20
AT120026	16 ÷ 20
AT120027	16 ÷ 20
AT120028	16 ÷ 20
AT120029	16 ÷ 20
AT120030	16 ÷ 20

**PER LAVORAZIONI AGGIUNTIVE VEDI PAG. 76**  
For additional works see page 76  
Für zusätzliche bearbeitungen s. seite 76  
Por trabajos añadidos ves pag. 76

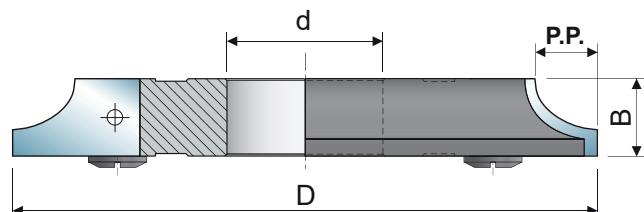

DISTINTA BASE / Bill of Materials						
DESCRIZIONE DESCRIPTION	CODICE					
	01÷05	06÷10	11÷15	16÷20	21÷25	26÷30
Coltello Sagomato / Profiled Knife	4	/	/	/	/	/
Coltello Sagomato / Profiled Knife	/	4	/	/	/	/
Coltello Sagomato / Profiled Knife	/	/	4	/	/	/
Coltello Sagomato / Profiled Knife	/	/	/	4	/	/
Coltello Sagomato / Profiled Knife	/	/	/	/	4	/
Coltello Sagomato / Profiled Knife	/	/	/	/	/	4
Cuneo Sagomato / Profiled Wedge	4	/	/	/	/	/
Cuneo Sagomato / Profiled Wedge	/	4	/	/	/	/
Cuneo Sagomato / Profiled Wedge	/	/	4	/	/	/
Cuneo Sagomato / Profiled Wedge	/	/	/	4	/	/
Cuneo Sagomato / Profiled Wedge	/	/	/	/	4	/
Cuneo Sagomato / Profiled Wedge	/	/	/	/	/	4
Vite per Cuneo / Wedges's Screw	4	8	8	8	8	12
Vite di Riferimento / Positioning Screw	4	4	4	4	4	4
Chiave per Cuneo / Wedge's Key	1	1	1	1	1	1

AT110		CODICE CODE
DIMENSIONI mm		CSAT200
	20 x 20/25 x 2	CSAT201
	30 x 20/25 x 2	CSAT202
	40 x 20/25 x 2	CSAT203
	50 x 20/25 x 2	CSAT204
	60 x 20/25 x 2	CSAT205
	80 x 20/25 x 2	CU155
	19 x 17 x 8	CU156
	29 x 17 x 8	CU157
	39 x 17 x 8	CU158
	49 x 17 x 8	CU159
	59 x 17 x 8	CU160
	79 x 17 x 8	OG001
	Ø13 x 9	VT012
	M5 x 7 Ø16	CH004
	Esagonale 4	

AT115		CODICE CODE
DIMENSIONI mm		CSAT206
	20 x 25/30 x 2	CSAT207
	30 x 25/30 x 2	CSAT208
	40 x 25/30 x 2	CSAT209
	50 x 25/30 x 2	CSAT210
	60 x 25/30 x 2	CSAT211
	80 x 25/30 x 2	CU161
	19 x 22 x 8	CU162
	29 x 22 x 8	CU163
	39 x 22 x 8	CU164
	49 x 22 x 8	CU165
	59 x 22 x 8	CU166
	79 x 22 x 8	OG001
	Ø13 x 9	VT012
	M5 x 7 Ø16	CH004
	Esagonale 4	

AT120		CODICE CODE
DIMENSIONI mm		CSAT212
	20 x 30/35 x 2	CSAT213
	30 x 30/35 x 2	CSAT214
	40 x 30/35 x 2	CSAT215
	50 x 30/35 x 2	CSAT216
	60 x 30/35 x 2	CSAT217
	80 x 30/35 x 2	CU167
	19 x 25 x 8	CU168
	29 x 25 x 8	CU169
	39 x 25 x 8	CU170
	49 x 25 x 8	CU171
	59 x 25 x 8	CU172
	79 x 25 x 8	OG001
	Ø13 x 9	VT012
	M5 x 7 Ø16	CH004
	Esagonale 4	

	
<p><b>Boccola per gruppi di utensili</b> Sleeve for tool's set</p>	<p><b>Boccola per gruppi di utensili</b> + <b>Set Anelli</b> Sleeve for tool's set + Spacer rings' set</p>